

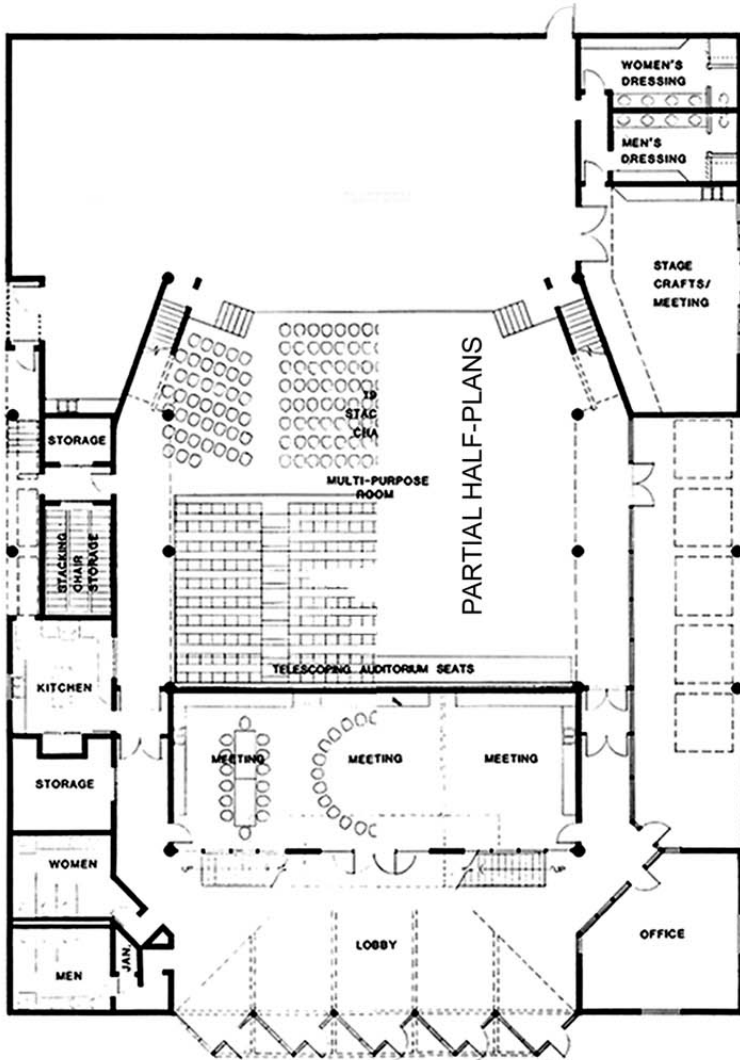

# MCH

MCKAY CONANT HOOVER INC  
Acoustics and Media Systems Consultants



The Oceanview Pavilion offers a variety of options for events ranging from 2 to 1,000 guests within its 14,000sf footprint. Telescoping tiered seating accommodates 700 guests in theater mode and when retract accommodates classroom, banquet, or rock concert arrangements with 1,200 capacity standing room. Included is a large, divisible conference room, 7 different breakout rooms as well as outdoor Patio areas overlooking a stream and an ocean view. The kitchen offers catering options. Opened in 1987 as a city-operated multi-purpose facility, it lived up to its billing very nicely as being a successful multi-purpose "on purpose" facility until its transition to a more commercial enterprise. It remains unique and overwhelmingly successful as a popular gathering space for all ages and audiences. MCH provided full-scope acoustical and audiovisual design.

Reference: Scott Ellinwood, Architect 805.684.0593

Visit: [www.oceanviewinfo.com](http://www.oceanviewinfo.com)



OCEANVIEW PAVILION  
PORT HUENEME, CA